

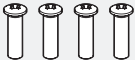

Junction box for wall mounts and dual-sensor IP cameras

DWC-WMJUNCW

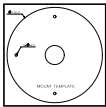

WHAT'S IN THE BOX					
Mounting Screws 4mm × 12mm		4	Screws and Plastic Anchors		3
Screws for Electronic Gang Plate Installation		3	Mounting Template		1

- NOTE:** Download all your support materials and tools in one place.
1. Go to: <http://www.digital-watchdog.com/resources>
 2. Search your product by entering the part number in the **'Search by Product'** search bar. Results for applicable part numbers will populate automatically based on the part number you enter.
 3. Click **'Search'**. All supported materials, including manuals and quick start guide (QSGs) will appear in the results.



INSTALLATION

Installation with a wall mount bracket:

- 1 Mark and drill the necessary holes on the mounting surface.
- 2 Secure the junction box to the mounting surface using the three (3) screws and wall anchors included.
- 3 When using an electric gang box (DWC-GPLT-W), mount the junction box to the #1 holes on the DWC-GPLT-W.
- 4 Secure the wall mount to the junction box using the four (4) screws included with the junction box. Keep the mounting pad from the wall mount.
- 5 Pass wires through and make all necessary connections.

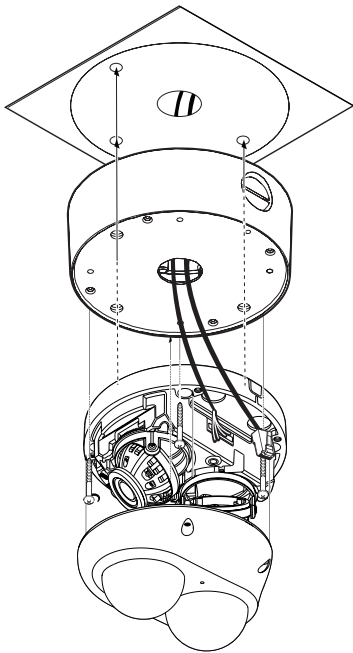
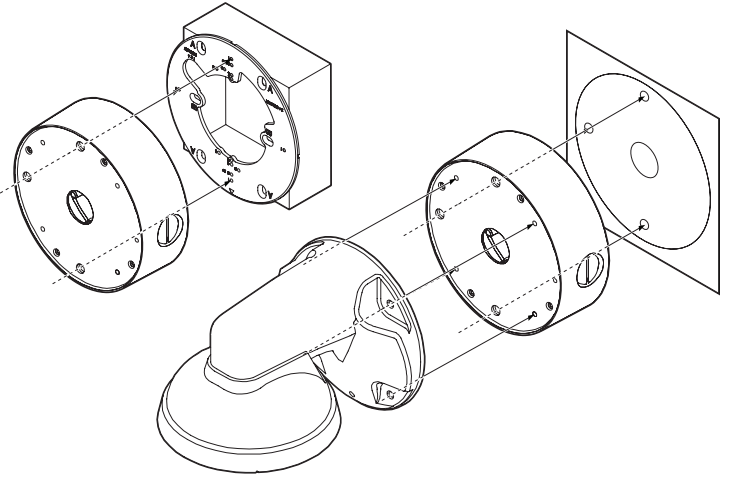

Installation with dual-sensor IP camera:

- 1 Secure the junction box to the mounting surface. See instructions above.
- 2 Remove the dome from the camera.

NOTE: Do not touch the lenses when handling the camera modules.

- 3 Pass wires through and make all the necessary connections.
- 4 Secure the camera to the mounting bracket using the four (4) screws included.
- 5 Adjust the camera's lens and place the cover dome on the camera.

Installation with a DWC-XSBF bullet IP camera:

- 1 Mark and drill the necessary holes on the mounting surface.
- 2 Secure the junction box to the mounting surface using the three (3) screws and wall anchors included.
- 3 Secure the bullet camera to the junction box using the four (4) screws included with the junction box. Keep the mounting pad from the wall mount.
- 4 Pass wires through and make all necessary connections.

